

LEGEND	
	PROPOSED CONTOURS @ 0.1m
	FUTURE DESIGN CONTOURS @ 0.1m
	EXISTING DESIGN CONTOURS @ 0.1m
	FINISHED DESIGN SURFACE ALLOTMENT LEVELS
	EXISTING SURFACE ALLOTMENT LEVELS
	DIRECTION OF FALL ACROSS ALLOTMENTS
	EXTENT OF WORKS
	EXTENT OF INTERIM SWALE
	STORMWATER PIPES
	EXISTING STORMWATER
	STORMWATER JUNCTION BOX
	STORMWATER SIDE ENTRY PIT
	STORMWATER HEADWALL REFER TO CITY OF PLAYFORD STANDARD DETAIL SD350. INCLUDE 230mm THICK RENO MATTRESS FOR EXTENTS SHOWN ON SD350.
	PIT NUMBER
	PRAM RAMP
	DRIVEWAY (BY OTHERS)
	FOOTPATH

FOR CONTINUATION REFER DRAWING AEV753-001-DW-CV-GEN-8015

STORMWATER PIT SCHEDULE

PIT NAME	EASTING	NORTHING	PIT TYPE
A01	284918.181	6162944.942	DOUBLE SEP (LINTEL TYPE)
A02	284915.277	6162938.353	DOUBLE SEP (LINTEL TYPE)
B01	284906.883	6162940.385	JUNCTION PIT (900X900)
B02	284899.437	6162935.389	DOUBLE SEP (LINTEL TYPE)
B03	284879.334	6162889.259	DOUBLE SEP (LINTEL TYPE)
B03-1	284872.826	6162892.552	DOUBLE SEP (LINTEL TYPE)
C01	284897.753	6162871.978	DOUBLE SEP (LINTEL TYPE)
C02	284895.066	6162865.299	DOUBLE SEP (LINTEL TYPE)
D01-1	284870.144	6162863.193	DOUBLE SEP (LINTEL TYPE)
D01	284882.591	6162863.301	JUNCTION PIT (900X900)
D02	284861.221	6162814.622	DOUBLE SEP (LINTEL TYPE)
D02-1	284854.637	6162817.535	DOUBLE SEP (LINTEL TYPE)
D03	284842.687	6162770.271	JUNCTION PIT (900X900)
D04	284832.680	6162764.394	JUNCTION PIT (900X900)
D05	284808.983	6162756.275	DOUBLE SEP (LINTEL TYPE)
D05-1	284806.532	6162763.045	DOUBLE SEP (LINTEL TYPE)
D06	284796.039	6162748.305	JUNCTION PIT (900X900)
D07	284797.910	6162732.985	2x 1900 x 900 DOUBLE SEP (LINTEL TYPE)*
D07-1	284791.140	6162730.534	2x DOUBLE SEP (LINTEL TYPE)
HW1	284759.805	6162716.704	HEADWALL OUTLET

STORMWATER PIT SCHEDULE (STUBS)

PIT NAME	EASTING	NORTHING	PIT TYPE
STUB	284948.130	6162923.383	SW STUB CAPPED END
STUB 1	284801.362	6162725.437	SW STUB CAPPED END
JB1	284761.578	6162716.087	JUNCTION PIT (1200X900)

NOTE:
ALL ALLOTMENT FILL TO BE PLACED AND COMPACTED UNDER LEVEL 1 SUPERVISION. TOP SOIL ON AREAS OF CUT AND FILL TO BE STRIPPED, STOCKPILED ON SITE AND RE-SPREAD AT COMPLETION OF WORKS. CONTRACTOR TO ALLOW FOR ALL SURPLUS SPOIL TO BE DISPOSED OF OFF SITE.

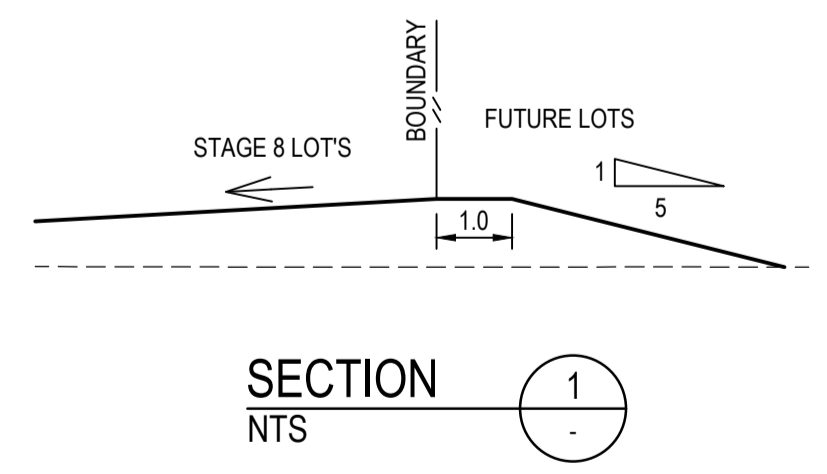

ALLOTMENT GRADING & STORMWATER LAYOUT PLAN

SCALE 1:500

- NOTES:**
- THE EASTING & NORTHING OF SEPs REFER TO ITS CENTRE AT KERB WATER TABLE.
 - TOP OF PIT LEVELS FOR SEPs ARE TO TOP OF KERB.
 - THE EASTING & NORTHING OF JUNCTION BOXES REFER TO ITS GEOMETRIC CENTRE.
 - CONTRACTOR TO LOCATE & DEPTH ALL EXISTING SERVICES AFFECTED BY THE WORKS.
 - ANY DAMAGE TO CABLES OR SERVICES ARE TO BE REPAIRED AT THE CONTRACTOR'S EXPENSE.
 - REFER TO DRG AEV753-001-DW-CV-GEN-8013 FOR STORMWATER DETAILS.
 - FOR PIPE LENGTHS, CLASS AND MATERIAL REFER STORMWATER LONGITUDINAL SECTIONS ON SHEETS AEV753-001-DW-CV-GEN-8011;
 - ALL JUNCTION BOXES TO HAVE HEAVY DUTY (CLASS D) COVERS AND FRAMES.

FOR CONSTRUCTION

FILE: O:\GIB\CAD\PROJECTS\AEV753\008\STAGE 8\DRAWINGS\CIVIL\AEV753-001-DW-CV-GEN-8003.DWG DATE: Friday, 15 July 2022 4:51:56 PM © Kellogg Brown & Root

REV	DESCRIPTION	DATE	POSITION	NAME	SIGNATURE
	DRAFTING CHECK		A. TEAKLE	A.T.	
	ORIGINATE/DESIGN		S. HUTTON	S.H.	
	INDEPENDENT CHECK		B. CHUA	B.C.	
	TECHNICAL APPROVAL		M. PAGE	M.P.	
	PROJECT APPROVAL		M. PAGE	M.P.	
	CLIENT APPROVAL				
0	ISSUED FOR CONSTRUCTION	17.03.22			

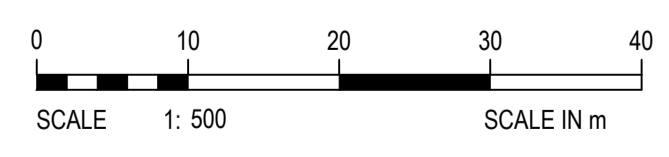

TITLE
LANSER COMMUNITIES
ANGLE VALE
NOTO STAGE 8
ALLOTMENT GRADING & STORMWATER LAYOUT PLAN

DRAWING SCALE
1:500;
DRAFTER: MB

ORIG. SIZE
A1

DRAWING No.
AEV753-001-DW-CV-GEN-8003

REVISION
0