

LEGEND

- 62.20 PROPOSED CONTOURS @ 0.1m
- EXISTING CONTOURS @ 0.1m
- 33.05 FINISHED DESIGN SURFACE ALLOTMENT LEVELS
- 33.05 EXISTING DESIGN LOT FILL LEVELS
- 33.05 EXISTING SURFACE ALLOTMENT LEVELS
- ← DIRECTION OF FALL ACROSS ALLOTMENTS
- EXTENT OF WORKS
- SW STORMWATER PIPES
- SW EXISTING STORMWATER
- STORMWATER JUNCTION BOX
- STORMWATER SIDE ENTRY PIT
- TEMPORARY SANDBAG HEADWALL
- A1 PIT NUMBER
- A PRAM RAMP
- DRIVEWAY (BY OTHERS)
- FOOTPATH
- EASEMENT
- EXISTING GROUNDWATER BOREHOLE
- RETAINING WALL

NOTES:

1. THE EASTING & NORTHING OF SEPs REFER TO ITS CENTRE AT KERB WATER TABLE.
2. TOP OF PIT LEVELS FOR SEPs ARE TO TOP OF KERB.
3. THE EASTING & NORTHING OF JUNCTION BOXES REFER TO ITS GEOMETRIC CENTRE.
4. CONTRACTOR TO LOCATE & DEPTH ALL EXISTING SERVICES AFFECTED BY THE WORKS.
5. ANY DAMAGE TO CABLES OR SERVICES ARE TO BE REPAIRED AT THE CONTRACTOR'S EXPENSE.
6. REFER TO DRG AEV753-11-DW-CV-GEN-2013 FOR STORMWATER DETAILS.
7. FOR PIPE LENGTHS, CLASS AND MATERIAL REFER STORMWATER LONGITUDINAL SECTIONS ON SHEETS AEV753-11-DW-CV-GEN-2014.
8. ALL JUNCTION BOXES TO HAVE HEAVY DUTY (CLASS D) COVERS AND FRAMES.

NOTE:
ALL ALLOTMENT FILL TO BE PLACED AND COMPACTED UNDER LEVEL 1 SUPERVISION. TOP SOIL ON AREAS OF CUT AND FILL TO BE STRIPPED, STOCKPILED ON SITE AND RE-SPREAD AT COMPLETION OF WORKS. CONTRACTOR TO ALLOW FOR ALL SURPLUS SPOIL TO BE DISPOSED OF OFF SITE.

| PIT SCHEDULE | | | |
|--------------|------------|-------------|---|
| PIT NAME | EASTING | NORTHING | PIT TYPE |
| C0 | 283843.754 | 6162962.511 | 1200 x 1200 JUNCTION BOX. CONSTRUCT ON EXISTING 600 RCP. CONFIRM EXISTING IL PRIOR TO CONSTRUCTION. |
| C1 | 283845.369 | 6162961.771 | 3 NO. ONE-PIECE KERB INLET (1800 OPENING) ON 900 x 750 JUNCTION BOX. (REFER DETAIL SHEET 2013) |
| C2 | 283852.193 | 6162960.343 | ONE-PIECE KERB INLET (1800 OPENING, SAG GRATE POSITION) ON 900 x 750 JUNCTION BOX |
| C3 | 283857.766 | 6162971.409 | DOUBLE SEP |
| D0 | 283873.703 | 6163026.278 | 900 x 900 JUNCTION BOX. CONSTRUCT ON EXISTING 600 RCP. CONFIRM EXISTING IL PRIOR TO CONSTRUCTION. |
| D1 | 283909.070 | 6163009.390 | DOUBLE SEP |
| D2 | 283905.890 | 6163002.598 | DOUBLE SEP |
| E0 | 283972.170 | 6162842.393 | HEADWALL |
| E1 | 283973.931 | 6162846.863 | TRIPLE SEP |
| E2 | 284007.810 | 6162919.235 | TRIPLE SEP |
| E3 | 284001.018 | 6162922.415 | TRIPLE SEP |
| E1-A | 283967.139 | 6162850.043 | DOUBLE SEP |

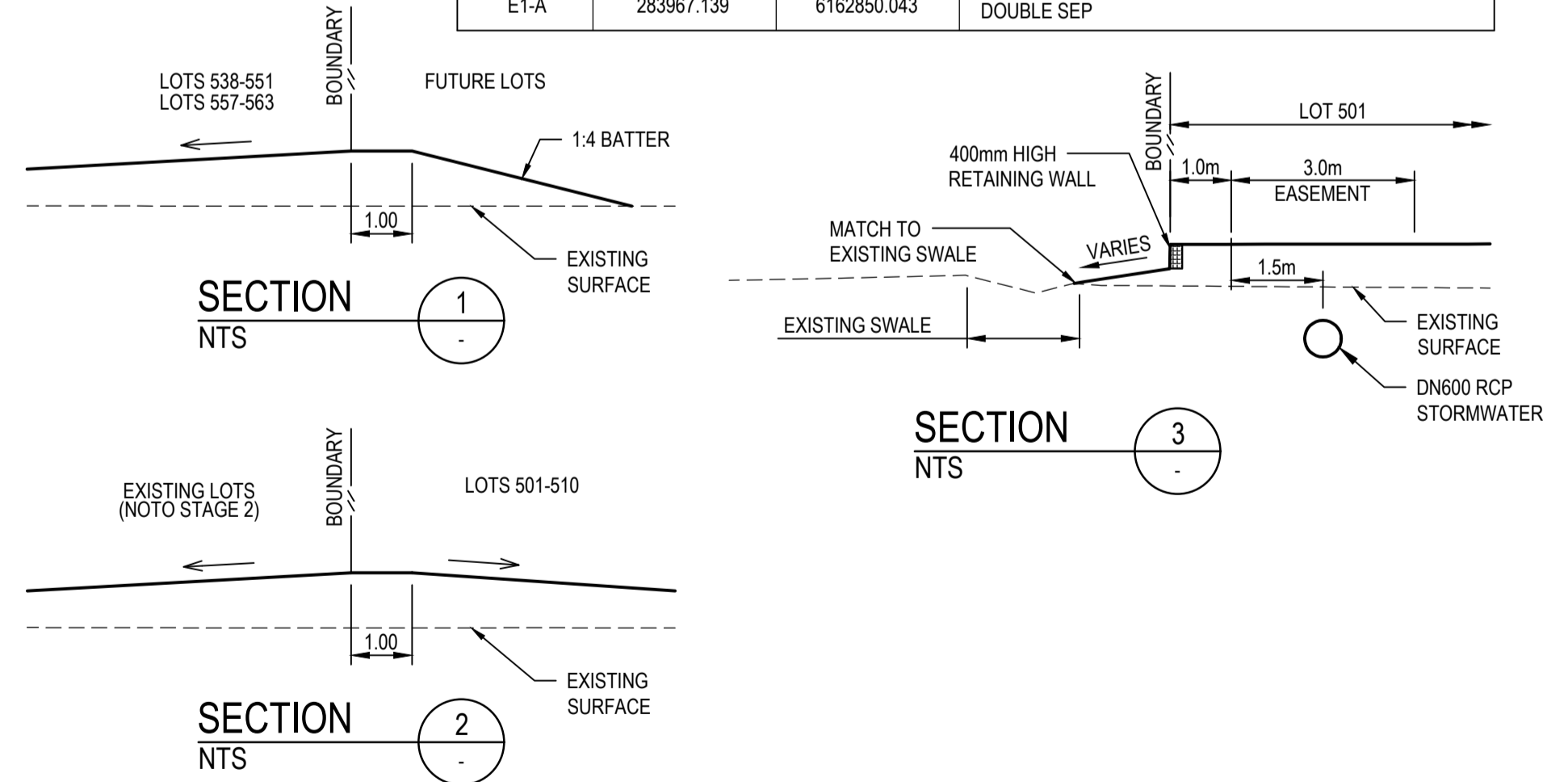

ALLOTMENT GRADING & STORMWATER LAYOUT PLAN
SCALE 1: 500

MATCHLINE - FOR CONTINUATION REFER SHEET 2016

FOR CONSTRUCTION

DATE: Thursday, 10 September 2020 3:15:05 PM FILE: C:\PROJECTS\LANSEVALE\DWG\AEV753-11-DW-CV-GEN-2003.DWG

| REV | DESCRIPTION | DATE | POSITION | NAME | SIGNATURE |
|-----|----------------------------|----------|--------------------|----------|-----------|
| 1 | RE-ISSUED FOR CONSTRUCTION | 10.09.20 | DRAFTING CHECK | D. SMITH | D.S. |
| 0 | ISSUED FOR CONSTRUCTION | 06.08.20 | ORIGINATOR/DESIGN | M. PAGE | M.P. |
| | | | INDEPENDENT CHECK | B. CHUA | B.C. |
| | | | TECHNICAL APPROVAL | M. PAGE | M.P. |
| | | | PROJECT APPROVAL | M. PAGE | M.P. |
| | | | CLIENT APPROVAL | | |

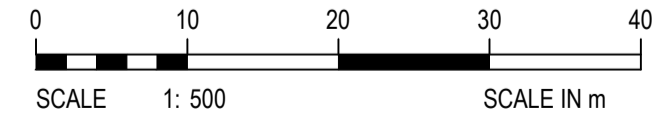

TITLE
LANSEVALE COMMUNITIES
ANGLE VALE
POLIFRONE & MUSICO STAGE 2
ALLOTMENT GRADING & STORMWATER LAYOUT PLAN

| | | | |
|-------------------------------|-------------------------|--|----------------------|
| DRAWING SCALE 1:500 | ORIG. SIZE A1 | DRAWING No. AEV753-11-DW-CV-GEN-2003 | REVISION 1 |
|-------------------------------|-------------------------|--|----------------------|