

- POP** PRIVATELY OPERATED PAYPHONES
- APS** ASSISTANCE TELEPHONES (EG ELEVATOR AND ROADSIDE PHONES)
- MET** APPLY TO OTHER TYPE OF METERING POINT (any service)
- ATM** ATM
- PRK** BANDSTAND / ROTUNDA / SPORTS FIELD STANDS / OTHER PARK BUILDING
- PSD** POINT OF SALE DEVICE (vending machine, ticket machine)
- TRF** Traffic Lights / Traffic Light Controller / Variable Speed Sign / Traffic Signal
- PBT** Public Transport (bus stop, tram stop, railway station, taxi rank, ferry wharf)
- SWT** Links / Link Pole / MV / HV Links / ABC Links / Dynamic Switch / Airbrake Switch / Isolator
- WAT** Water Infrastructure (storage, pumps, valves water supply, waste water, sewerage stations)
- GAS** Natural Gas Infrastructure
- CAM** Camera (security / traffic)
- CTL** Bridge control, swing bridge, traffic control gates, railway boom gates)
- MOB** Mobile Phone Tower / radio antenna
- LIT** Street Lighting Pole / street light controller
- CAR** Unmanned (council) car park
- PWR** Transformer / Kiosk / Pad Mount Sub-station / Pole Mount Transformer
- NAP-ID** Network Access Point (NAP)
- MPT-ID** Multiport (MPT)
n is the number of ports (eg 4,6,8,12)
- Penetration**

- TJL-ID** Splice Joint on a Transit Cable (TJL)
- DJL-ID** Splice Joint on a Distribution Cable (DJL)
- LJL-ID** Splice Joint on a Local Cable (LJL)
- MJL-ID** Splice Joint on a Tether Cable (MJL)
- AJL-ID** Zone Terminal / Splice Joint (AJL)
- FDH-ID** Fibre Distribution Hub-FDH Cabinet with Cabinet ID shown
- PIT-ID 2** Service Drop Access Pit (650mmX280mmX565mm)
- PIT-ID 5** Network Boundary/Local Network Pit (Single Lid) (700mmX450mmX650mm)
- PIT-ID 6** Distribution/Local Network Connection Pit (Dual Lid) (1360mmX555mmX650mm)
- PIT-ID 8** Distribution/Local Network Connection Pit (1360mmX555mmX860mm)
- PIT-ID 9** Fibre Distribution Hub (FDH) Pit (2000mmX555mmX900mm)
- NTD** Shared Trench
- NTD** nbn NTD
- OBBU** NBN Optional Battery Backup Unit
- PDH** nbn Premises Distribution Hub
- CTL** nbn Cable Transition Location
- FDT** nbn Fibre Distribution Terminal
- FIP** nbn NTD Fire Indicator Panel
- Riser** Riser
- LIFT** nbn NTD LIFT
- AP** Access Panel
- SEC** nbn NTD Security
- CET** nbn Communications Earth Terminal
- DES QTY** Example of descriptor box that will show the type of work and the quantity involved
- nbn manhole**
- Existing Telstra manhole**
- FAN AAAA** Fan Access Node site (FAN)
- 138A^{RX}_{CX}** Multi Dwelling Unit (MDU)

- DEPTH-- ALIGN--** DEPTH OVER ALIGNMENT SYMBOL TO BE USED WITH EVERY MARKER POST
- X** Symbol to be used when replacing/removing existing network
- PCD** Premise Connection Device (PCD)
- POLE-ID** Pole (showing pole identity)
- 5** Existing Telstra Pit (2,3,4,5,6,7,8,9) Telstra exchange
- T** Example of Telstra Major Conduit Layout with Proposed duct marked to be used by NBN
- M < - >** NBN MARKER POST MARKER POST TO BE NUMBERED

CONDUIT CONFIGURATION

CONDUITS AND DUCTS ARE IN LAYER : < L460 NBN Support - Underground > AND TERMINOLOGY CATEGORIZED INTO TWO GROUPS IN THE DRAWING AS PER BELOW:

1- DUCT USED WITH LOCAL NETWORK

2-CONDUIT USED WITH LEAD-IN DROPS

ATTRIBUTES ATTACHED ARE AS SHOWN

CABLE CONFIGURATION

CABLE TYPE: CABLES DIVIDE INTO FOLLOWING CATEGORIES AND ARE COLOUR CODED:

TRANSIT CABLES	COLOUR NO: 1	312F
DISTRIBUTION CABLES	COLOUR NO: 190	288F
LOCAL CABLES	COLOUR NO: 4	144F
TETHER CABLES	COLOUR NO: 3	12F
LEAD IN (DROP) CABLES	COLOUR NO: 5	1F

CABLE LOCATION: CABLE LOCATIONS DETERMINES WHERE THE CABLE IS USED AS PER BELOW:

IN-CONDUIT	288F
AERIAL	144F
BURIED	96F

EXAMPLE:

144 FIBRE AERIAL LOCAL CABLE	144F
1 FIBRE BURIED DROP CABLE	1F
432 FIBRE IN-CONDUIT TRANSIT CABLE	48F

CABLE SIZE: CABLE SIZE IS THE TOTAL NUMBER OF OPTIC FIBRES IN THE CABLE AND IS DETERMINED BY A NUMBER FOLLOWED BY F (FIBRE) OR R (RIBBON) IN THE MIDDLE OF THE LINE TYPE

LINE TYPES ARE CATEGORIZED INTO 3 TYPES:

- IN-CONDUIT: (XXXXF) 312F, ...
- AERIAL: (XXXXF_A) 144_A, ...
- BURIED: (XXXXF_B) 12_B, ...

Boundaries: FSA Boundary, FSAM Boundary, FDA Boundary

STAFF WORKING ON THIS ESTIMATE PLEASE NOTE:
The location of other authorities services which may affect this work have not been obtained by the estimator. Constructor to obtain service information before commencing.



SAFETY FIRST
SAFETY STARTS WITH YOU



REV	DATE	DRAFTER	DESCRIPTION	APPROVED
-				
-				
-				
E	30/07/20	C.RIGBY	AMENDMENTS ROAD F AND H AS HIGHLIGHTED	
D	19/06/20	C.RIGBY	AMENDMENT TO CURTIS RD CROSSING ALIGNMENT	
C	18/06/20	C.RIGBY	FOR CONSTRUCTION	
B	27/05/20	C.RIGBY	REVISED DRAFT FOR REVIEW	
A	29/04/20	C.RIGBY	DRAFT FOR REVIEW	

STRICTLY CONFIDENTIAL

NBNCO APPROVAL RECORD:

SIGNATURE	DATE
<input type="checkbox"/> DD	_____
<input type="checkbox"/> WD	_____
<input type="checkbox"/> AB	_____

QUALITY RECORD :

NBNCO DISCLAIMER
THIS DOCUMENT HAS BEEN PREPARED SOLELY FOR THE USE OF NBNCO LIMITED (ABN 86 136 533 741) FOR USE IN MAINTAINING NBNCO FACILITIES. IT HAS NOT BEEN CREATED FOR ANY OTHER USE. IT SHOULD NOT BE SCALED TO LOCATE NBNCO ASSETS. NO WARRANTY IS GIVEN THAT THE INFORMATION IS ACCURATE OR COMPLETE.

KEY PLAN

DRAWING TITLE:
M000014126
MIRAVALE MUSICO
STAGE 1
PIT AND PIPE DESIGN

ENABLE#: 279174

STATE: SA REGION:

FSA: SAM: ADA:

PROJECT No: M000014126

CADREF No: LF 2053

SCALE N/A SHEET No. 001 OF 002 REV. E

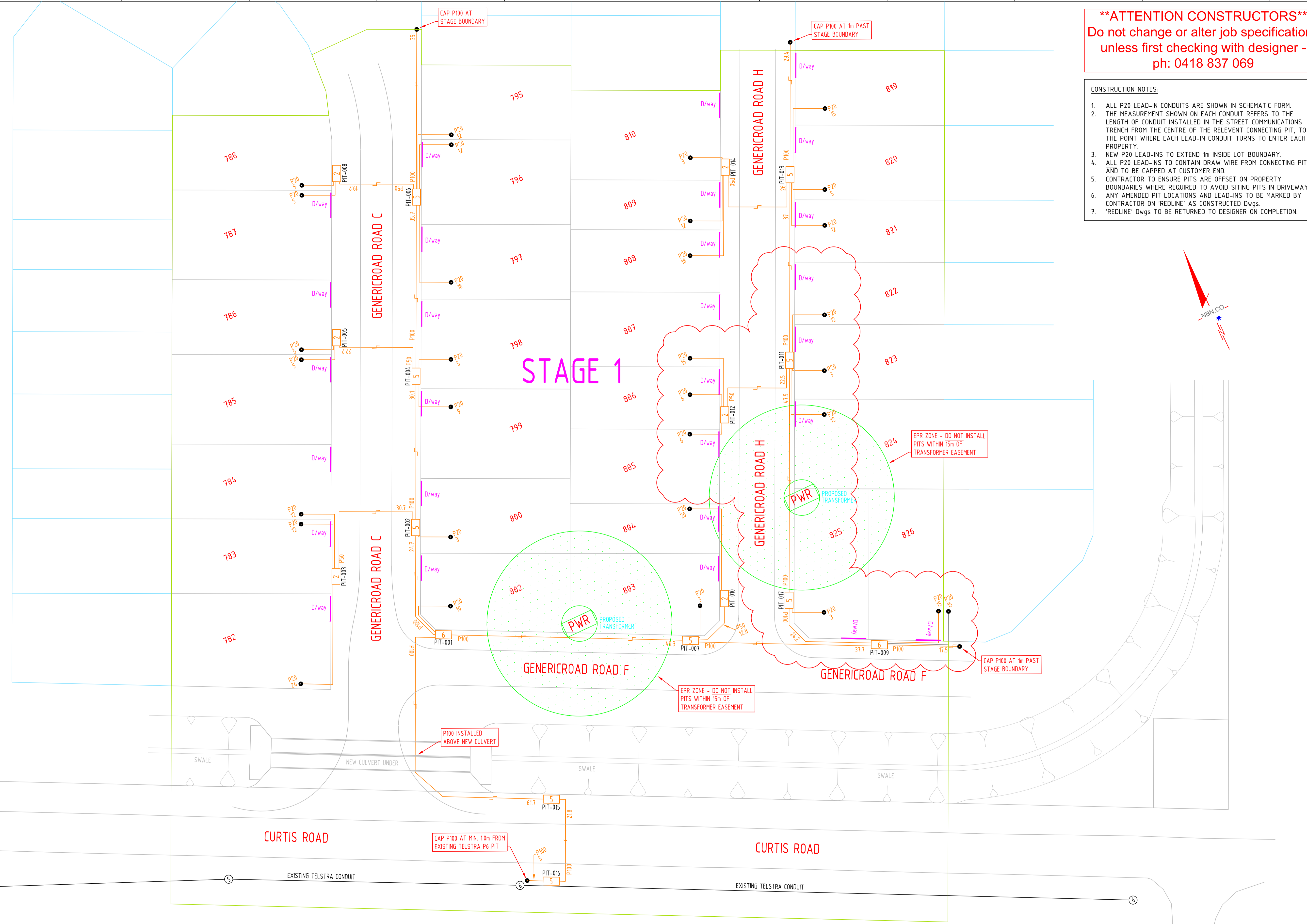

****ATTENTION CONSTRUCTORS****
 Do not change or alter job specifications
 unless first checking with designer -
 ph: 0418 837 069

- CONSTRUCTION NOTES:**
- ALL P20 LEAD-IN CONDUITS ARE SHOWN IN SCHEMATIC FORM.
 - THE MEASUREMENT SHOWN ON EACH CONDUIT REFERS TO THE LENGTH OF CONDUIT INSTALLED IN THE STREET COMMUNICATIONS TRENCH FROM THE CENTRE OF THE RELEVANT CONNECTING PIT, TO THE POINT WHERE EACH LEAD-IN CONDUIT TURNS TO ENTER EACH PROPERTY.
 - NEW P20 LEAD-INS TO EXTEND 1m INSIDE LOT BOUNDARY.
 - ALL P20 LEAD-INS TO CONTAIN DRAW WIRE FROM CONNECTING PIT AND TO BE CAPPED AT CUSTOMER END.
 - CONTRACTOR TO ENSURE PITS ARE OFFSET ON PROPERTY BOUNDARIES WHERE REQUIRED TO AVOID SITING PITS IN DRIVEWAYS. ANY AMENDED PIT LOCATIONS AND LEAD-INS TO BE MARKED BY CONTRACTOR ON 'REDLINE' AS CONSTRUCTED DWGS.
 - 'REDLINE' DWGS TO BE RETURNED TO DESIGNER ON COMPLETION.

FOR CONSTRUCTION

BILL OF MATERIAL

NO OF LOTS: 30

PITS		DUCTS	
SIZE	QTY	SIZE	QTY MTRS
2	6	P100	14 457
5	9	P50	6 133.4
6	2	P20	30 297
8	0		
9	0		

TOTAL NUMBER OF PITS: 17
 TOTAL NUMBER OF MANHOLES: 0
 TOTAL NUMBER OF CONDUITS: 50
 TOTAL LENGTH OF CONDUITS: 887.4

SDU Development Information

Development Name: MIRAVALE MUSICO
 Developer Company: LANCER COMMUNITIES
 Development Address: Heaslip Road, Angle Vale, SA
 Authorised Rep: Shaun Bowden
 Phone: 08-8132-1115
 E-Mail: sbowden@lanser.com.au
 nbn Reference Number: M000014126
 Stage Number: 1
 Design Revision: E

- STANDARD SEPARATIONS AND CONSTRUCTION NOTES:**
- PITS SHOULD BE INSTALLED AT LEAST 15.0m AWAY FROM EPR ZONES
 - PITS SHOULD BE INSTALLED 1000MM CLEAR FROM OTHER COMMS PITS
 - CONDUITS SHOULD BE INSTALLED 300MM CLEAR FROM TV CABLES
 - CONDUITS SHOULD BE INSTALLED 150MM CLEAR FROM GAS PIPES 110MM OR LESS
 - CONDUITS SHOULD BE INSTALLED 100MM CLEAR FROM ALL OTHER SERVICES
 - HORIZONTAL SEPARATION TO OTHER SERVICES INSIDE PROPERTY IS 150MM
 - DEPTH OF COVER FOR COMMS CONDUITS:
 ROAD CROSSINGS - 600MM
 VERGE - 450MM
 SERVICE DROP CONDUIT - 300MM

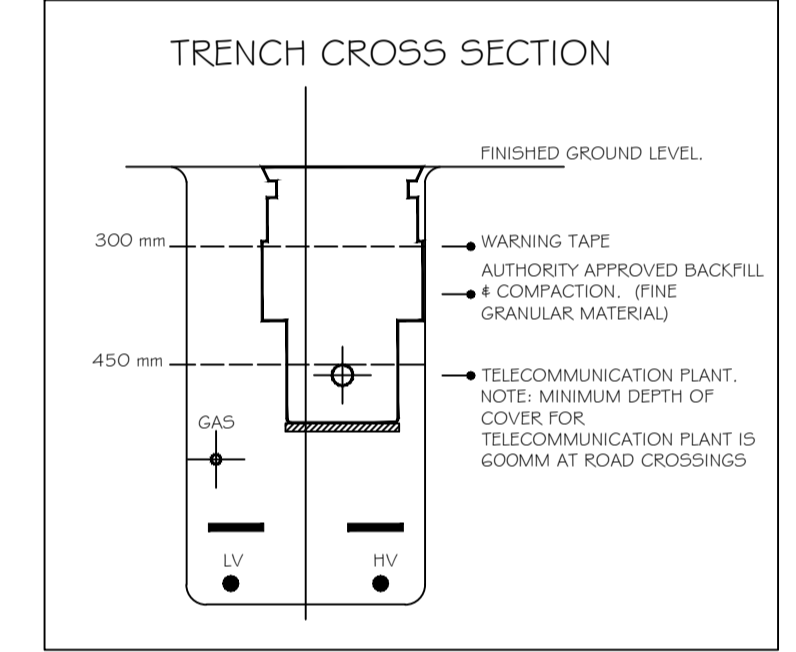

PIT DIMENSIONS TABLE - By Type & Size

PIT TYPE	Length	Width	Depth
P2 Pit	650mm	280mm	565mm
P5 Pit	700mm	450mm	650mm
P6 Pit	1360mm	555mm	650mm
P8 Pit	1360mm	555mm	860mm
P9 Pit	2040mm	550mm	900mm

DEVELOPMENT No. --- / D--- / --
 HUNDRED OF
 IN THE AREA OF
 TOWN OF
 MAP REF:
 GRID REF:

THIS ESTATE HAS BEEN DESIGNED FROM
 DEVELOPER SUPPLIED PLANS

DRAWING No. : -
 REV : -
 ISSUE DATE : -

SCOPE OF WORKS:
 DESIGN RETICULATION OF 30 LOT ESTATE WITH PIT & PIPE TO SUIT
 NBN GUIDELINES.

NOTE 1:
 PROJECT HAS BEEN DESIGNED TO NBNCo. GUIDELINES.
 ANY CONSTRUCTION CARRIED OUT BY DEVELOPERS/CONSTRUCTORS
 BASED ON THIS PLAN ARE TO BE CARRIED OUT AT OWN RISK.
 REFER TO NBNCo. WEB SITE FOR GUIDELINES FOR DEVELOPERS
 NBN-TE-STO-194.

NOTE 2:
 ENSURE THAT THE INSTALLATION OF ALL P50 ROAD CROSSINGS ARE
 SET AS CLOSE TO 90 DEGREES AS POSSIBLE.

NOTE 3:
 NO CONDUIT INFRASTRUCTURE INCLUDED IN THIS DESIGN IS TO BE
 CONNECTED TO ANY EXISTING INFRASTRUCTURE THAT IS NOT OWNED
 BY THE DEVELOPER.

NOTE 4:
 ALL CONDUIT IS LOCAL UNLESS NOTED OTHERWISE.

NOTE 5:
 CONTRACTOR TO SEAL AND BURY 100mm CONDUIT AT END OF
 PROVIDED SHARED TRENCH TO NBNCo. GUIDELINES.

NOTE 6:
 REFER TO POWER/ELECTRICAL DESIGN FOR MINIMUM CLEARANCE
 DISTANCE REQUIRED BETWEEN ELECTRICAL PILLAR OR PIT AND
 TELECOMMUNICATIONS PIT.



REV	DATE	DRAFTER	DESCRIPTION	APPROVED
-				
-				
E	30/07/20	C.RIGBY	AMENDMENTS ROAD F AND H AS HIGHLIGHTED	
D	19/06/20	C.RIGBY	AMENDMENT TO CURTIS RD CROSSING ALIGNMENT	
C	18/06/20	C.RIGBY	FOR CONSTRUCTION	
B	27/05/20	C.RIGBY	REVISED DRAFT FOR REVIEW	
A	29/04/20	C.RIGBY	DRAFT FOR REVIEW	

STRICTLY CONFIDENTIAL

NBNCO APPROVAL RECORD:

SIGNATURE	DATE
<input type="checkbox"/> DD	
<input type="checkbox"/> WD	
<input type="checkbox"/> AB	

QUALITY RECORD:

NBNCO DISCLAIMER
 THIS DOCUMENT HAS BEEN PREPARED SOLELY FOR THE USE OF
 NBNCO LIMITED (ABN 86 136 533 741) FOR USE IN MAINTAINING
 NBNCO FACILITIES. IT HAS NOT BEEN CREATED FOR ANY OTHER
 USE. IT SHOULD NOT BE SCALED TO LOCATE NBNCO ASSETS. NO
 WARRANTY IS GIVEN THAT THE INFORMATION IS ACCURATE OR
 COMPLETE.

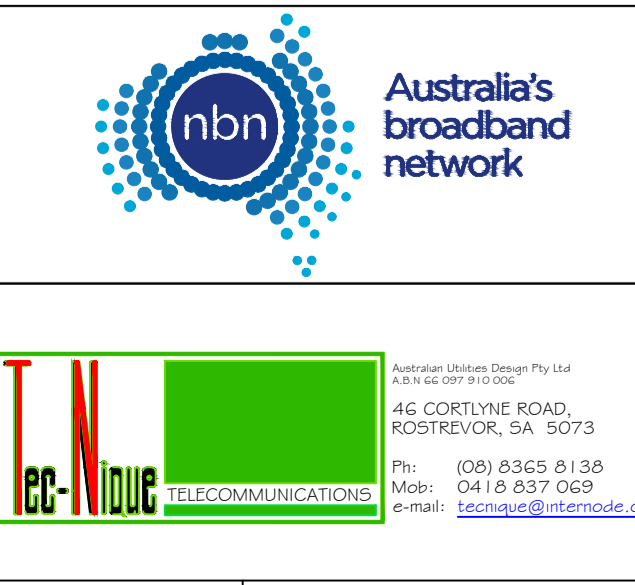

KEY PLAN

001

DRAWING TITLE:
 M000014126
 MIRAVALE MUSICO
 STAGE 1
 PIT AND PIPE DESIGN

ENABLE#: 279174

STATE: SA REGION:

FSA: SAM: ADA:

PROJECT No: M000014126

CADREF No: LF 2053

SCALE: N/A SHEET No: 002 OF 002 REV: E