

LEGEND

- 62.20 PROPOSED CONTOURS @ 0.1m
- - - - - EXISTING CONTOURS @ 0.1m
- 33.05 FINISHED DESIGN SURFACE ALLOTMENT LEVELS
- × 33.05 EXISTING SURFACE ALLOTMENT LEVELS
- ← DIRECTION OF FALL ACROSS ALLOTMENTS
- - - - - EXTENT OF WORKS
- SW — STORMWATER PIPES
- STORMWATER JUNCTION BOX
- STORMWATER SIDE ENTRY PIT
- STORMWATER HEADWALL, REFER CITY OF PLAYFORD STANDARD SD351 DRAWING FOR DETAILS
- ⊙ PIT NUMBER
- ▴ PRAM RAMP
- ▭ DRIVEWAY (BY OTHERS)
- ▭ FOOTPATH
- ⊗ EXISTING TREE TO BE REMOVED
- ⊗ EXISTING INFRASTRUCTURE TO BE REMOVED

- NOTES:**
1. THE EASTING & NORTHING OF SEPs REFER TO ITS CENTRE AT KERB WATER TABLE.
 2. TOP OF PIT LEVELS FOR SEPs ARE TO TOP OF KERB.
 3. THE EASTING & NORTHING OF JUNCTION BOXES REFER TO ITS GEOMETRIC CENTRE.
 4. CONTRACTOR TO LOCATE & DEPTH ALL EXISTING SERVICES AFFECTED BY THE WORKS.
 5. ANY DAMAGE TO CABLES OR SERVICES ARE TO BE REPAIRED AT THE CONTRACTOR'S EXPENSE.
 6. REFER TO DRG AEV753-11-DW-CV-GEN-1017 FOR STORMWATER DETAILS.
 7. FOR PIPE LENGTHS, CLASS AND MATERIAL REFER STORMWATER LONGITUDINAL SECTIONS ON SHEETS AEV753-11-DW-CV-GEN-1018; 1019;
 8. ALL JUNCTION BOXES TO HAVE HEAVY DUTY (CLASS D) COVERS AND FRAMES.

STORMWATER PIT SCHEDULE			
PIT NAME	EASTING	NORTHING	PIT TYPE
A00	284083.154	6162531.241	BANDAGE JOINT
A01	284083.851	6162533.524	DOUBLE SEP (LINTEL TYPE)
A02	284090.113	6162538.065	900 x 900 JUNCTION BOX
A03	284099.317	6162535.991	DOUBLE SEP (LINTEL TYPE)
A04	284148.183	6162511.056	900 x 900 JUNCTION BOX
A05	284155.835	6162526.310	DOUBLE SEP (LINTEL TYPE)
A06	284193.157	6162606.391	DOUBLE SEP
A07	284199.950	6162603.211	DOUBLE SEP
B01	284063.196	6162541.798	CONNECT TO HEADWALL C01
B02	284077.055	6162544.710	1200 x 1200 JUNCTION BOX
B03	284083.190	6162554.929	DOUBLE SEP (LINTEL TYPE)
B04	284129.154	6162651.513	DOUBLE SEP (LINTEL TYPE)
B05	284128.751	6162657.598	SW STUB CAPPED END
A03A	284102.513	6162542.466	DOUBLE SEP (LINTEL TYPE)
B03A	284093.369	6162554.659	DOUBLE SEP (LINTEL TYPE)
A05A	284162.356	6162523.258	DOUBLE SEP (LINTEL TYPE)
D00	284073.183	6162535.979	BANDAGE JOINT
D01	284074.687	6162538.057	DOUBLE SEP (LINTEL TYPE)
C03	284063.020	6162539.490	HW OUTLET
C04	284092.032	6162525.169	HW INLET
C05	284061.746	6162536.884	HW OUTLET
C06	284090.748	6162522.568	HW INLET

NOTE:
REFER AEV753-11-DW-CV-GEN-1015 FOR SWALE DETAILS.

ALLOTMENT GRADING & STORMWATER LAYOUT PLAN
SCALE 1: 500

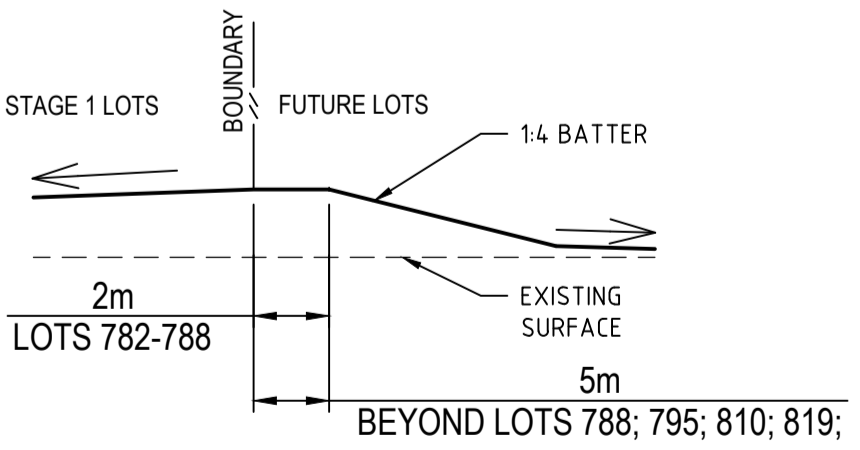

SECTION 1
NTS

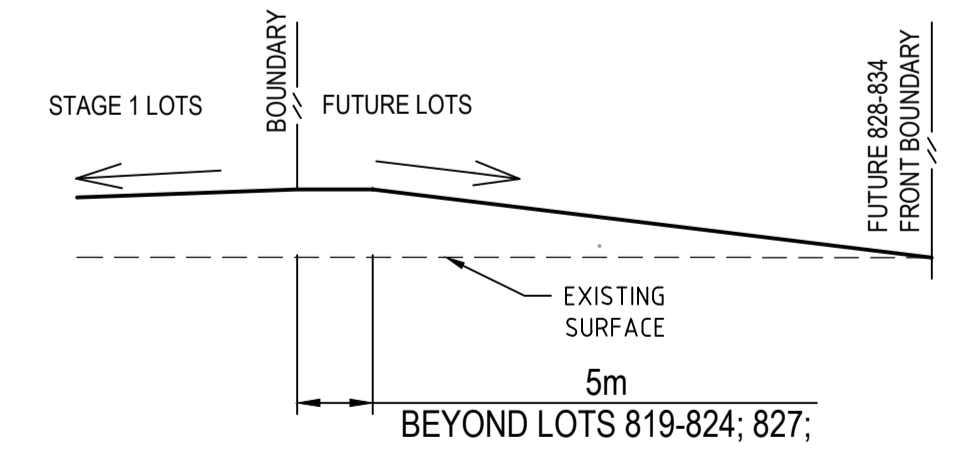

SECTION 2
NTS

NOTE:
ALL ALLOTMENT FILL TO BE PLACED AND COMPACTED UNDER LEVEL 1 SUPERVISION. TOP SOIL ON AREAS OF CUT AND FILL TO BE STRIPPED, STOCKPILED ON SITE AND RE-SPREAD AT COMPLETION OF WORKS.

FOR CONSTRUCTION

FILE: O:\GAMCAD\PROJECTS\AEV753-11-DW-CV-GEN-1003.DWG DATE: Tuesday, 14 July 2020 11:54:07 AM © Kellogg Brown & Root

REV	DESCRIPTION	DATE	POSITION	NAME	SIGNATURE
	DRAFTING CHECK		D. SMITH	D.S.	
	ORIGINATE/DESIGN		M. PAGE	M.P.	
	INDEPENDENT CHECK		B. CHUA	B.C.	
	TECHNICAL APPROVAL		M. PAGE	M.P.	
	PROJECT APPROVAL		M. PAGE	M.P.	
0	ISSUED FOR CONSTRUCTION	15.07.20			

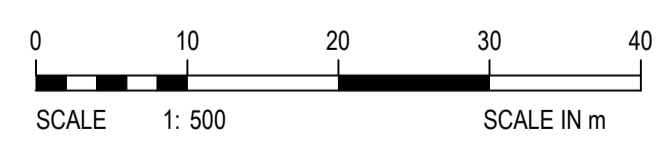

Kellogg Brown & Root Pty Ltd
ABN 91 007 660 317

DRAWING SCALE: 1:500
ORIG. SIZE: A1
DRAFTER: NK

TITLE
LANSER COMMUNITIES
ANGLE VALE
POLIFRONE & MUSICO STAGE 1
ALLOTMENT GRADING & STORMWATER LAYOUT PLAN

DRAWING No: **AEV753-11-DW-CV-GEN-1003**

REVISION: **0**