

FILE: O:\GBCAD\PROJECTS\AEV753\001\DW-CV-GEN-4002.DWG DATE: Wednesday, 17 June 2020 9:06:31 AM

**LEGEND**

**DESIGN SERVICES**

- SW STORMWATER PIPES
- S SEWER MAIN
- W POTABLE WATER MAIN
- CST COMMON SERVICE TRENCH (REFER ELECTRICAL DRAWINGS)
- FUTURE STORMWATER PIPES
- FUTURE SEWER MAIN
- FUTURE POTABLE WATER MAIN
- NEW SEWER CONNECTION
- ⊙ NEW SEWER MS
- NEW SEWER MH
- ⊙ POTABLE WATER SERVICE CONNECTIONS TO BE PLACED CENTRAL TO ALLOTMENT UNLESS SHOWN OTHERWISE REFER SA WATER DRAWINGS
- STORMWATER JUNCTION BOX
- STORMWATER DOUBLE SIDE ENTRY PIT
- ⊙ HOUSE/STORMWATER DRAINAGE CONNECTION TO BE INSTALLED 0.2m FROM BOUNDARY ON LOW SIDE OF ALLOTMENT (TYPICAL)
- STORMWATER HEADWALL. REFER CITY OF PLAYFORD STANDARD DRAWING FOR DETAILS
- IRRIGATION CONDUIT 1000 WITH DRAW WIRE.
  - 600mm COVER BENEATH ROAD PAVEMENT AND FUTURE DRIVEWAYS AND EXTEND 500mm FROM BACK OF KERB WITH MARKER TAPE BROUGHT TO THE SURFACE.
  - CONDUITS ARE ALSO TO BE PLACED UNDER FOOTPATH AT EACH PRAM RAMP. EACH ALLOTMENT WATER AND STORMWATER CONNECTION
  - REFER AEV753-001-DW-CV-GEN-4016 FOR DETAIL
- ⊙ PROPOSED ELECTRICAL PILLAR
- PROPOSED ELECTRICAL CONSUMER MAIN LEAD-IN
- PROPOSED ELECTRICAL PIT
- PROPOSED TRANSFORMER EASEMENT
- PROPOSED SWITCHING CUBICLE
- \* PROPOSED LIGHT POLE
- PRAM RAMP. TGS's & DETAILS AS PER COUNCIL PRAM RAMP DETAIL. REFER AEV753-001-DW-CV-GEN-4016. (TACTILE INDICATORS NOT SHOWN ON THIS DRAWING FOR CLARITY)
- DRIVEWAY (BY OTHERS)
- FOOTPATH
- BLOCK PAVED ROAD
- EXTENT OF WORKS

**EXISTING SERVICES**

- SW EXISTING STORMWATER
- S EXISTING SEWER MAIN
- W EXISTING WATER MAIN
- E EXISTING ELECTRICAL
- EXISTING SEWER CONNECTION
- ⊙ EXISTING SEWER MS
- EXISTING SEWER MH
- ⊙ EXISTING POTABLE WATER SERVICE
- EXISTING ELECTRICAL PILLAR
- EXISTING ELECTRICAL PIT
- EXISTING STORMWATER JUNCTION BOX
- EXISTING STORMWATER SIDE ENTRY PIT

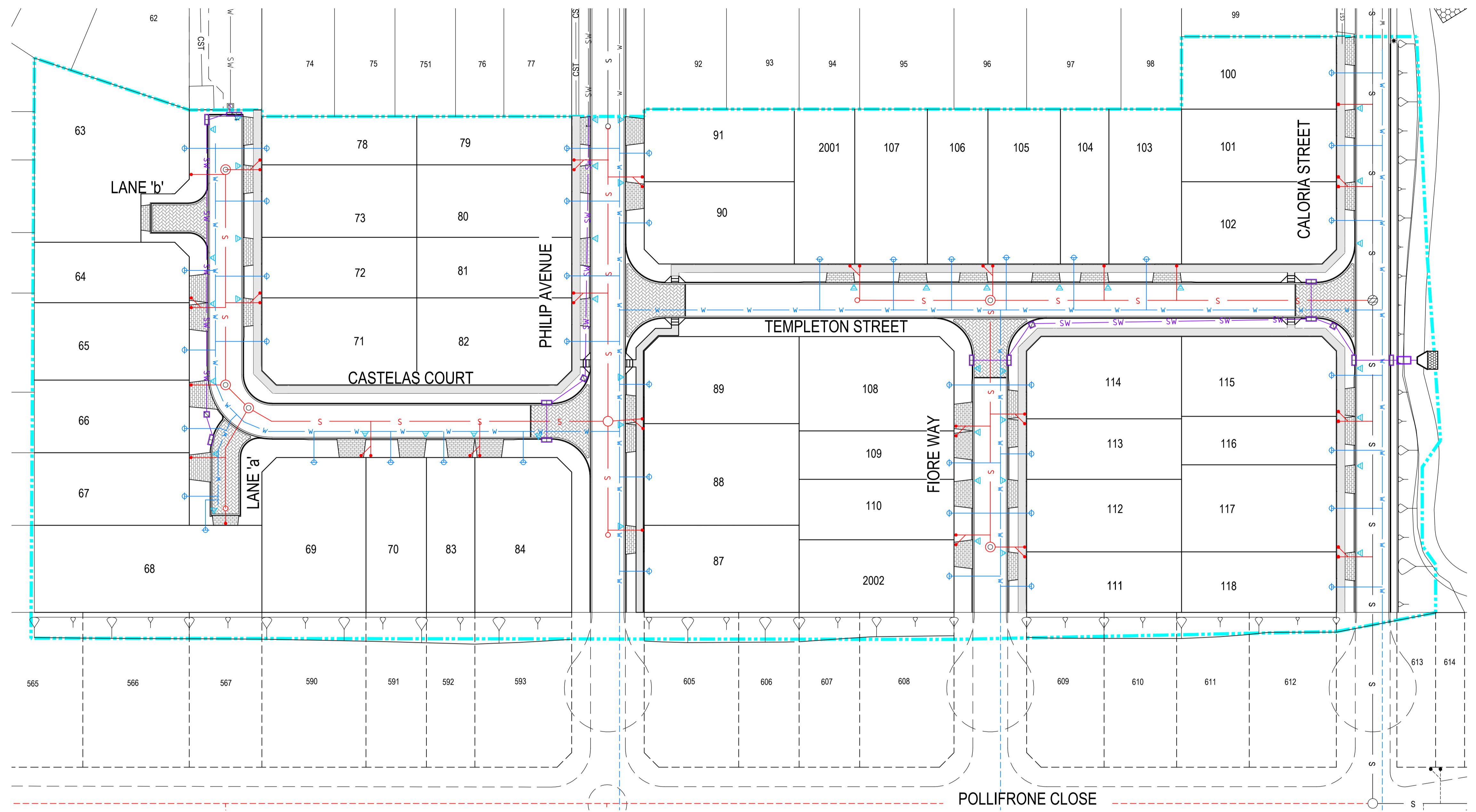

**NOTE:**

- REFER TO ELECTRICAL DRAWINGS FOR COMMON SERVICES TRENCH AND ELECTRICAL RETICULATION LAYOUT.

**SERVICES LAYOUT PLAN**  
SCALE 1: 500

CHECK PRINT - INCOMPLETE REVISION

NOT AUTHORISED FOR USE  
PLOT DATE: Jun 17, 2020 - 9:06am

NOT FOR CONSTRUCTION

REV	DESCRIPTION	DATE	POSITION	NAME	SIGNATURE
	DRAFTING CHECK			D. SMITH	D.S.
	ORIGINATE/DESIGN			M. PAGE	M.P.
	INDEPENDENT CHECK			B.CHUA	B.C.
	TECHNICAL APPROVAL			M. PAGE	M.P.
	PROJECT APPROVAL			M. PAGE	M.P.
	CLIENT APPROVAL				
B	ISSUED FOR REVIEW	17.06.2020			
A	ISSUED FOR REVIEW	19.05.2020			

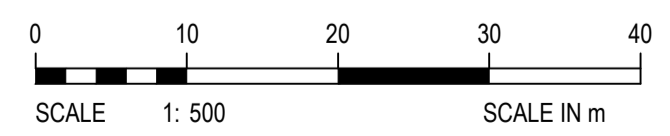

**TITLE**  
LANSEY COMMUNITIES  
ANGLE VALE  
STAGE 4  
SERVICES LAYOUT PLAN

DRAWING SCALE  
**1:500**  
DRAFTER: NK

ORIG. SIZE  
**A1**  
DRAWING No.  
**AEV753-001-DW-CV-GEN-4002**

REVISION  
**B**

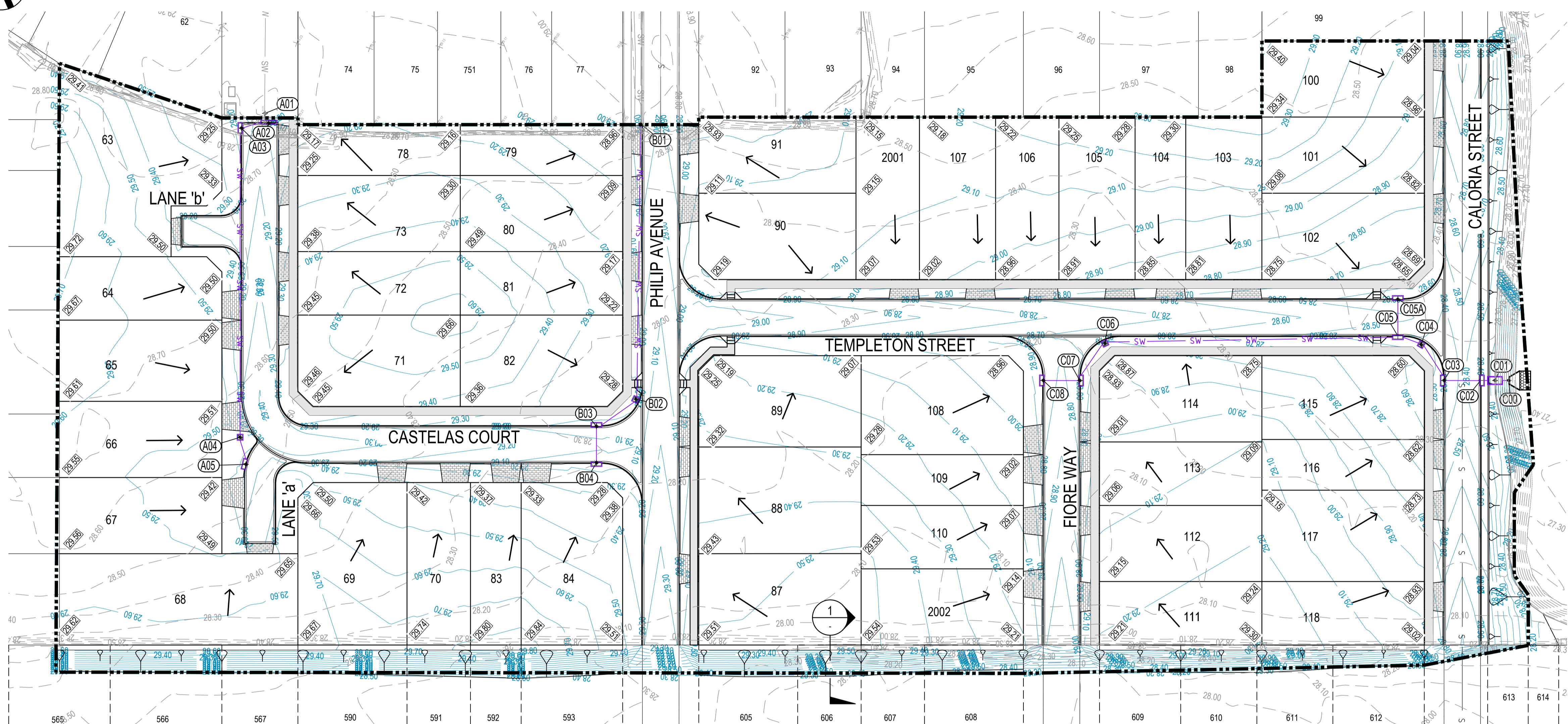

**LEGEND**

- 62.20 PROPOSED CONTOURS @ 0.1m
- EXISTING CONTOURS @ 0.1m
- FINISHED DESIGN SURFACE ALLOTMENT LEVELS
- EXISTING SURFACE ALLOTMENT LEVELS
- DIRECTION OF FALL ACROSS ALLOTMENTS
- EXTENT OF WORKS
- STORMWATER PIPES
- STORMWATER JUNCTION BOX
- STORMWATER SIDE ENTRY PIT
- STORMWATER HEADWALL INCLUDING 230mm THICK RENO-MATRESS, REFER CITY OF PLAYFORD STANDARD DRAWING FOR DETAILS
- PIT NUMBER
- PRAM RAMP
- DRIVEWAY (BY OTHERS)
- FOOTPATH

**NOTES:**

1. THE EASTING & NORTHING OF SEP'S REFER TO ITS CENTRE AT KERB WATER TABLE.
2. TOP OF PIT LEVELS FOR SEP'S ARE TO TOP OF KERB.
3. THE EASTING & NORTHING OF JUNCTION BOXES REFER TO ITS GEOMETRIC CENTRE.
4. CONTRACTOR TO LOCATE & DEPTH ALL EXISTING SERVICES AFFECTED BY THE WORKS.
5. ANY DAMAGE TO CABLES OR SERVICES ARE TO BE REPAIRED AT THE CONTRACTOR'S EXPENSE.
6. REFER TO DRG AEV753-001-DW-CV-GEN-4016 FOR STORMWATER DETAILS.
7. FOR PIPE LENGTHS, CLASS AND MATERIAL REFER STORMWATER LONGITUDINAL SECTIONS ON SHEETS AEV753-001-DW-CV-GEN-4017, 4018.
8. ALL JUNCTION BOXES TO HAVE HEAVY DUTY (CLASS D) COVERS AND FRAMES.

**ALLOTMENT GRADING & STORMWATER LAYOUT PLAN**  
SCALE 1: 500

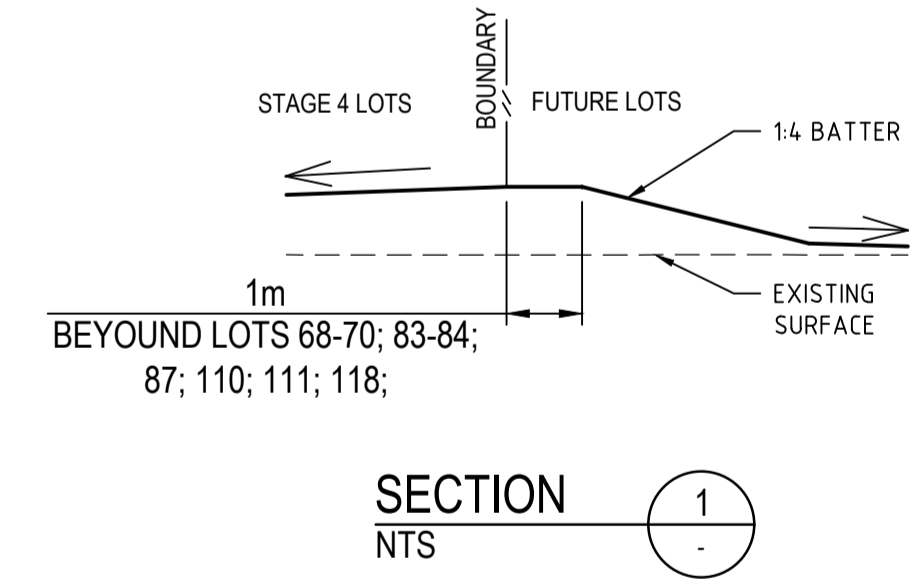

**NOTE:**  
ALL ALLOTMENT FILL TO BE PLACED AND COMPACTED UNDER LEVEL 1 SUPERVISION. TOP SOIL ON AREAS OF CUT AND FILL TO BE STRIPPED, STOCKPILED ON SITE AND RE-SPREAD AT COMPLETION OF WORKS.

**CHECK PRINT - INCOMPLETE REVISION**  
NOT AUTHORISED FOR USE  
PLOT DATE: Jun 17, 2020 - 9:07am

**NOT FOR CONSTRUCTION**

STORMWATER PIT SCHEDULE			
PIT NAME	EASTING	NORTHING	PIT TYPE
A01	284153.287	6163050.171	EXISTING PIPE STUB TO BE REMOVED AND EXISTING JUNCTION BOX TO BE ADJUSTED TO SUIT NEW PIPE
A02	284153.162	6163048.105	TRIPLE SEP
A03	284147.885	6163049.490	DOUBLE SEP
A04	284121.808	6162994.460	900 x 900 JUNCTION BOX
A05	284120.585	6162989.140	DOUBLE SEP
B01	284219.496	6163016.901	CONNECT TO EXISTING STORMWATER PIPE
B02	284195.639	6162968.180	900 x 900 JUNCTION BOX
B03	284186.343	6162966.655	DOUBLE SEP (LINTEL TYPE)
B04	284183.290	6162960.133	DOUBLE SEP (LINTEL TYPE)
C00	284353.000	6162898.579	HEADWALL OUTLET
C01	284350.566	6162899.719	URBAN ASSET SOLUTIONS (ECOSOL) GPT 4300
C02	284347.985	6162900.928	DOUBLE SEP (LINTEL TYPE)
C03	284341.464	6162903.980	DOUBLE SEP (LINTEL TYPE)
C04	284340.388	6162912.308	900 x 900 JUNCTION BOX
C05	284336.952	6162915.806	DOUBLE SEP (LINTEL TYPE)
C06	284284.049	6162938.959	900 x 900 JUNCTION BOX
C07	284276.436	6162934.421	DOUBLE SEP (LINTEL TYPE)
C08	284269.915	6162937.474	DOUBLE SEP (LINTEL TYPE)
C05A	284340.006	6162922.330	DOUBLE SEP (LINTEL TYPE)

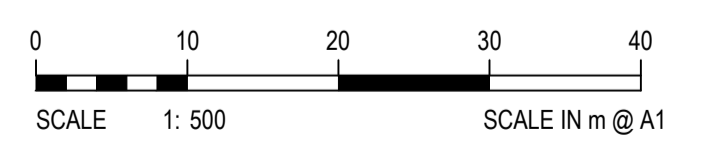

TITLE  
**LANSER COMMUNITIES**  
**ANGLE VALE**  
**STAGE 4**  
**ALLOTMENT GRADING & STORMWATER LAYOUT PLAN**

DRAWING SCALE  
**1:500**  
DRAFTER: NK

ORIG. SIZE  
**A1**  
DRAWING No.  
**AEV753-001-DW-CV-GEN-4003**

REVISION  
**B**

FILE: O:\GBCAD\PROJECTS\AEV753\001\DW-CV-GEN-4003.DWG  
 DATE: Wednesday, 17 June 2020 9:07:35 AM  
 © Kellogg Brown & Root

REV	DESCRIPTION	DATE	POSITION	NAME	SIGNATURE
	DRAFTING CHECK		D. SMITH	D.S.	
	ORIGINATE/DESIGN		M. PAGE	M.P.	
	INDEPENDENT CHECK		B.CHUA	B.C.	
	TECHNICAL APPROVAL		M. PAGE	M.P.	
	PROJECT APPROVAL		M. PAGE	M.P.	
B	ISSUED FOR REVIEW	17.06.2020			
A	ISSUED FOR REVIEW	19.05.2020			

NOT AUTHORISED FOR USE